

Edison



Compact Modular Fuse Holders

Branch Circuit and Supplementary
Electrical Protection

COOPER Circuit Protection



Modular Fuse Holder Specifications and Selection Guide

Features and Benefits

- High SCCR rated, UL Listed Class CC holder with indicator option for 600Vac/dc
- UL Recognized midjet and 10 x 38 holders
- Terminals rated for use with 75°C or 90°C wire, fine stranded wire, spade terminals and comb-bus bars. Use any higher temperature rated wire with appropriate derating
- Complete range of UL Listed and high SCCR rated 1- and 3-phase finger-safe comb-bus bars and power feed lugs

RoHS



Specifications

Agency Information: UL File E300536

Guide IZLT Listed, IZLT2 Recognized

CSA: File 47235; EHM - Class 6225-30,
EHCC - Class 6225-01

Ratings:

600V/30A (UL)

690V/32A (IEC)

Wire Range:

#18 to #4 (0.8 to 21.1mm²)

Torque Ratings:

30 Lb-In (3.4 N•m) maximum

Flammability Ratings:

UL 94V0, self-extinguishing

Storage & Operating Temperature Range:

-20°C to +90°C (indicating)

-20°C to +120°C (non-indicating)

Series & Size	Catalog Number		Voltage & Current	Agency Markings	Number of Poles	Terminal Rating	SCCR Rating	Edison Fuses
	With Indicator	Without Indicator						
EHM 10x38 and Midget	EHM1DIU	EHM1DU	UL 600V/30A; IEC 690V/32A	UR, IEC 60269-2, CSA	1	Solid, Stranded, Fine Stranded, Spade Lug, Comb-Bus Bar, Single and Dual Wire; 75°C and 90°C Cu wire	200kA rms sym	MCL, MOL, MEQ, MEN
	EHM2DIU	EHM2DU			2			
	EHM3DIU	EHM3DU			3			
EHCC Class CC	EHCC1DIU	EHCC1DU	UL 600V/30A	UL, CSA	1		200kA rms sym	EDCC, HCLR, HCTR
	EHCC2DIU	EHCC2DU			2			
	EHCC3DIU	EHCC3DU			3			

Modular Fuse Holder Features and Dimensions

Features

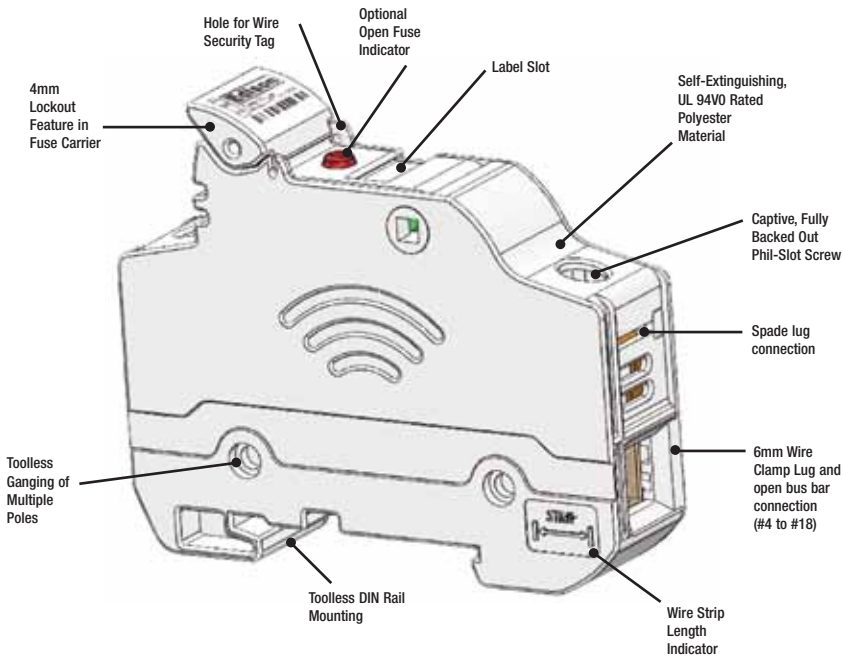

Multi-Pole Ganging

Use multi-pole connection kit part number EV-L to gang multiple poles together. One EV-L kit is sufficient to gang up to 4 poles.

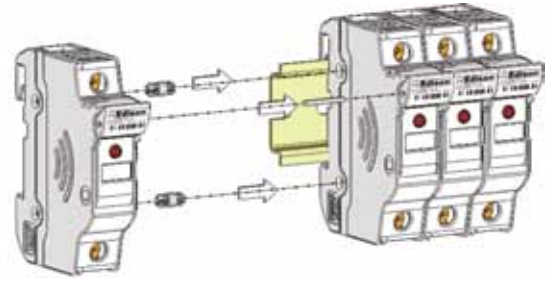

Removing Instructions

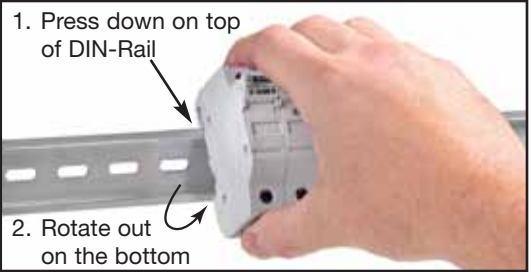

Dimensional Data - mm (in)

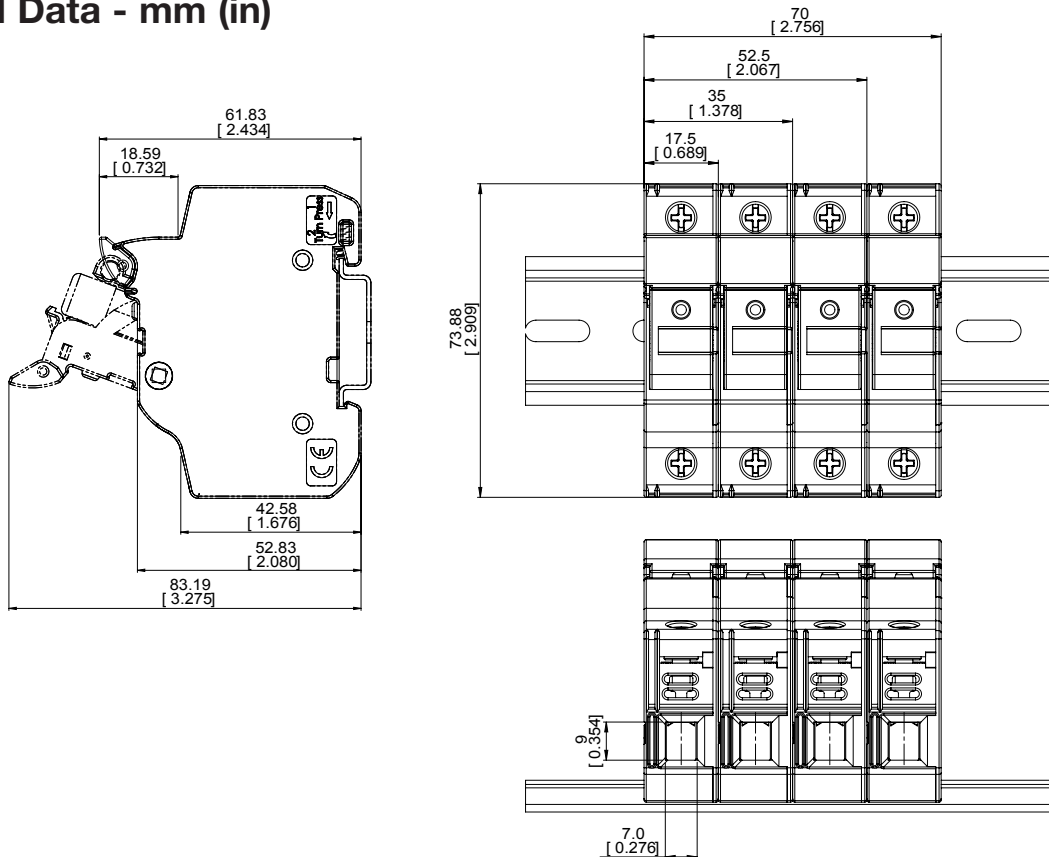

Features and Benefits

- Easily distribute power in single-phase or three-phase configurations
- Flexible cut-to-length solutions without compromising on the product's finger-safe features
- 100kA SCCR (Short Circuit Current Rating) when protected by a 200A Class J fuse
- Single-phase bus bars rated to 1000Vdc and 100A in end-fed configuration (200A for center-fed configuration)
- Three-phase bus bars rated to 600Vac/dc and 100A in end-fed configuration (200A for center-fed configuration)
- Power feed terminals for single-phase and three-phase service

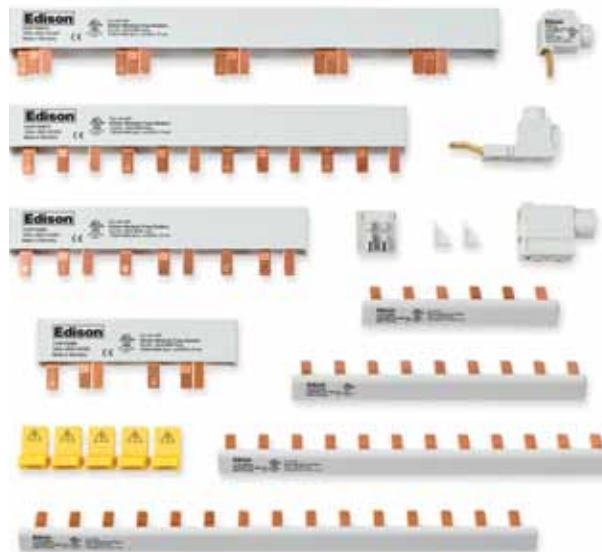

Specifications

Agency Information: UL508, File E195399

Pitch: 17.8mm

SCCR: 10kA (default)

100kA (with upstream Class J 200A fuses)

Max Current: 100A (power feed from end;
200A (power feed from center)

Max Voltage: 600Vac/dc (three phase)
1000Vdc/600Vac (single phase)



Selection Guide

Part Number	Description
EB1P100M3	Single-phase 1000Vdc busbar, 100A, 3 pins, assembled endcap
EB1P100M6	Single-phase 1000Vdc busbar, 100A, 6 pins, assembled endcap
EB1P100M9	Single-phase 1000Vdc busbar, 100A, 9 pins, assembled endcap
EB1P100M12	Single-phase 1000Vdc busbar, 100A, 12 pins, assembled endcap
EB1P100M15	Single-phase 1000Vdc busbar, 100A, 15 pins, assembled endcap
EB1P100M57	Single-phase 1000Vdc cuttable busbar, 100A, 57 pins, without endcap
EB3P100M6	Three-phase 600V busbar, 100A, 6 pins, assembled endcap
EB3P100M9	Three-phase 600V busbar, 100A, 9 pins, assembled endcap
EB3P100M12	Three-phase 600V busbar, 100A, 12 pins, assembled endcap
EB3P100M15	Three-phase 600V busbar, 100A, 15 pins, assembled endcap
EB3P100M57	Three-phase 600V cuttable busbar, 100A, 57 pins, without endcap
EECAP1P	Single-phase busbar endcap
EECAPMP	Three-phase busbar endcap
EPWR35MM	35mm ² feeder terminal for three-phase busbar (115A, 1000Vac/dc)
EPWR50MM	50mm ² direct-feed terminal for three-phase busbar (115A, 1000Vac/dc)
EFSCVR	Spare contact safety protection covers
EPWR1PLP	Single-phase low-profile feeder terminal (115A, 1000Vac/dc)

Comb-Bus Bar Installation and Dimensions

Typical Installation Example

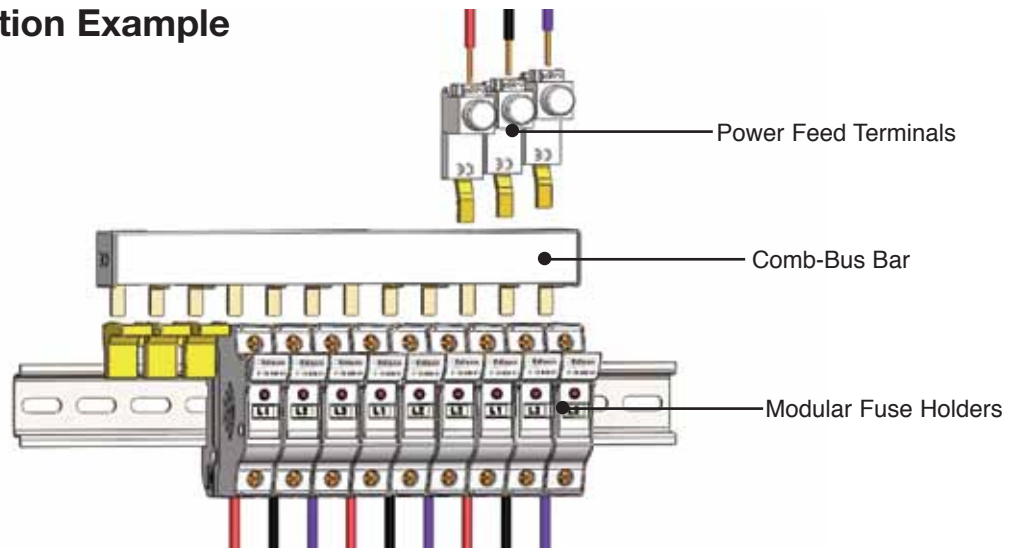

Typical Dimensional Data

Three-phase

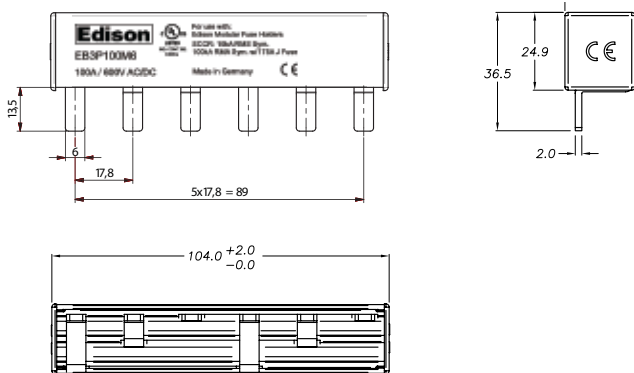

Single-phase

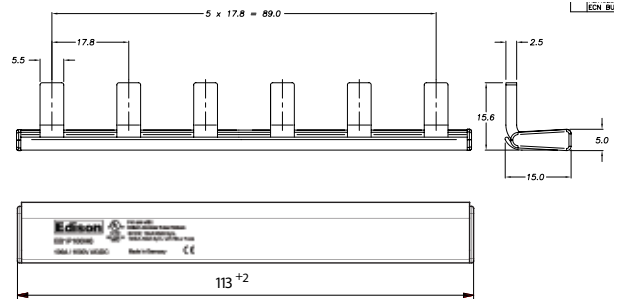

EECAP1P

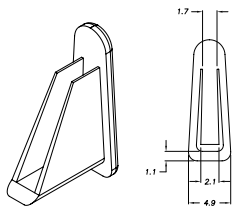

EECAPMP

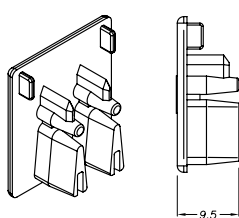

EFSCVR

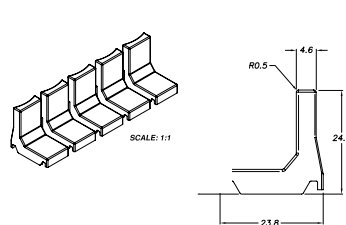

EPWR1PLP

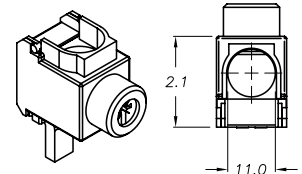

EPWR35MM

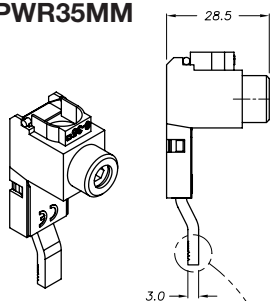

EPWR50MM

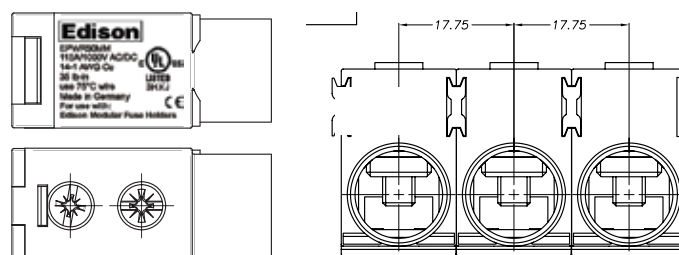

Customer Satisfaction - US and Canada

The Edison™ Customer Satisfaction team is a great resource for questions regarding all Edison products. Service hours are Monday through Friday, 8:00 a.m. – 4:30 p.m. CST.

The Customer Satisfaction team can be reached via:

- Phone: 636-391-3443
- Toll-free fax: 800-862-5178
- E-mail: edisonorders@cooperindustries.com

Online Resources

Visit www.edisonfuse.com for additional product information.

C3 – The Enhanced, Online Cooper Customer Center

Provides real time product availability, net pricing, order status & shipment for Edison distributors. Available at:

- www.cooperc3.com
- 877-995-5955 for log-in assistance

Edison
Cooper Circuit Protection
www.edisonfuse.com

Your Authorized Edison Distributor is:

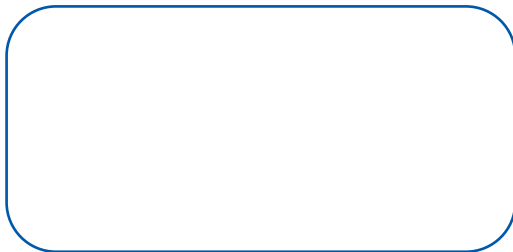

Cooper Industries, Ltd.
600 Travis, Ste. 5800
Houston, TX 77002-1001
P: 713-209-8400
www.cooperindustries.com

Reorder # 3195 0612

PDF Only

 **COOPER** Circuit Protection